

Walk Description

- A. This walk starts and finishes at the Station Inn Public house at Silkstone Common. Follow the road under the railway bridge.
- B. Turn right down Cone Lane then bear up to the right up Beacon Hill.
- C. Continue towards the railway line, turn right through the tunnel, then immediately left on the path leading to Hall Royd Lane.
- D. Pass Hall Royd farm, and continue up to the Water House and turn right.
- E. Follow the road down the hill to Ben Bank Road. From here if you want to shorten the walk you can return to Silkstone Common by turning right at this junction.
For the longer walk proceed left towards Dodworth as far as Ben Bank Farm, turning along at the second footpath sign on the right.
- F. Go down the concreted lane, follow it to the left, then right over the stile and down the field to the dismantled railway track now the Dove Valley Trail (TPT). Cross the trail, into the small field on the other side and on to another track.
- G. Cross this track into the wood then follow the fence round to the right round the edge of the wood and cross the footbridge. Follow the footpath towards the farm. Pass to the right of the farm following the yellow arrow waypoints to the road, turn left on the road.
- H. Walk as far as Falthwaite Grange Farm to look at its structure. Re-trace your steps back towards Silkstone Common, over House Carr Bridge up the hill to the footpath leading down the field to the right, almost opposite Dodworth Moor End.
- I. Follow the footpath down the field up through the wood, under the railway and turn left over the footbridge to Moorend Houses. Continue up the footpath by Equestrian Centre and recreation ground to Ben Bank Road. Turn left here and back to the Station Inn PH.

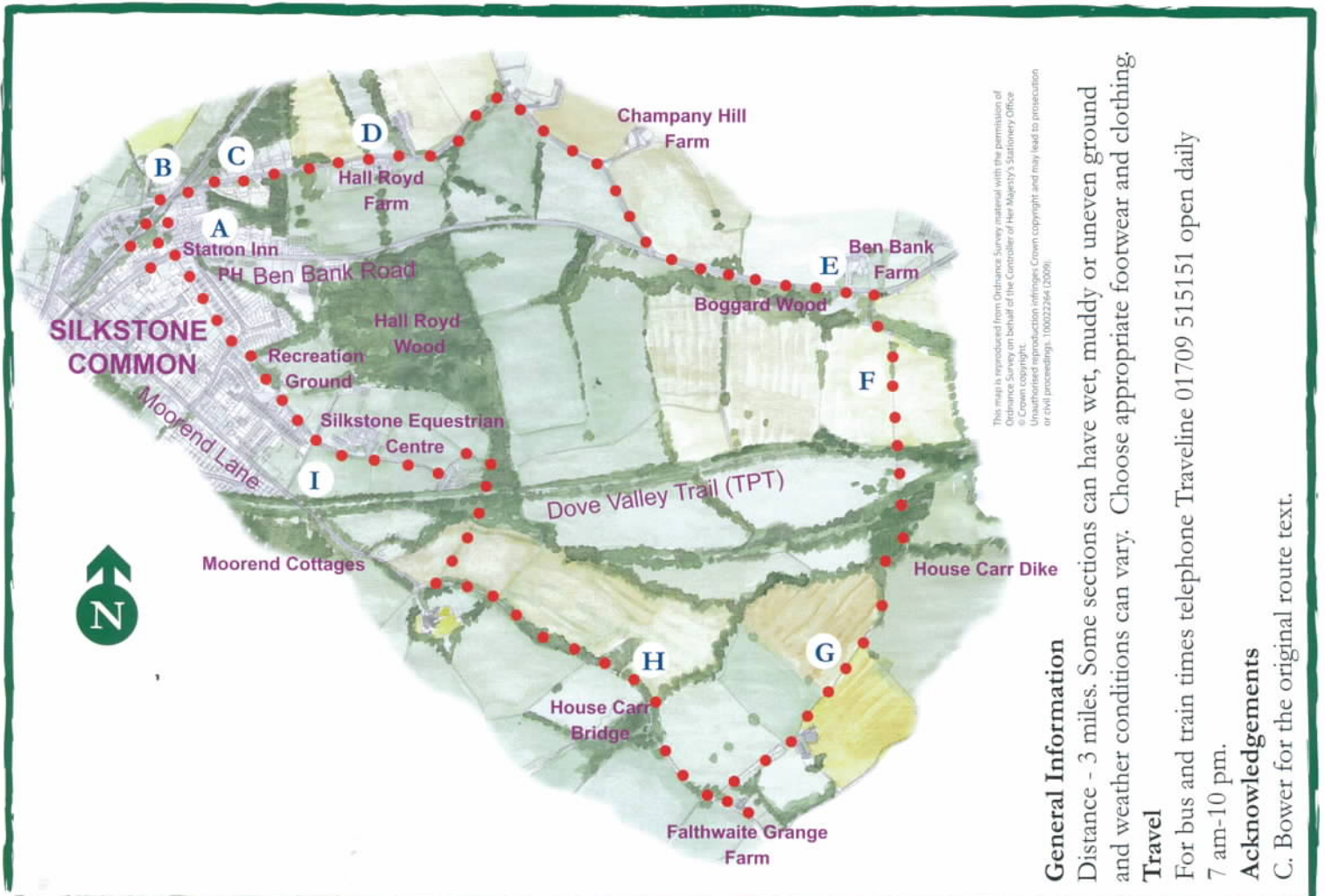

General Information

Distance - 3 miles. Some sections can have wet, muddy or uneven ground and weather conditions can vary. Choose appropriate footwear and clothing.

Travel

For bus and train times telephone Traveline 01709 515151 open daily 7 am-10 pm.

Acknowledgements

C. Bower for the original route text.